



---

 [www.c-sgroup.co.uk/381](http://www.c-sgroup.co.uk/381)

SECTION ON ELEVATION

HRW-6-S75

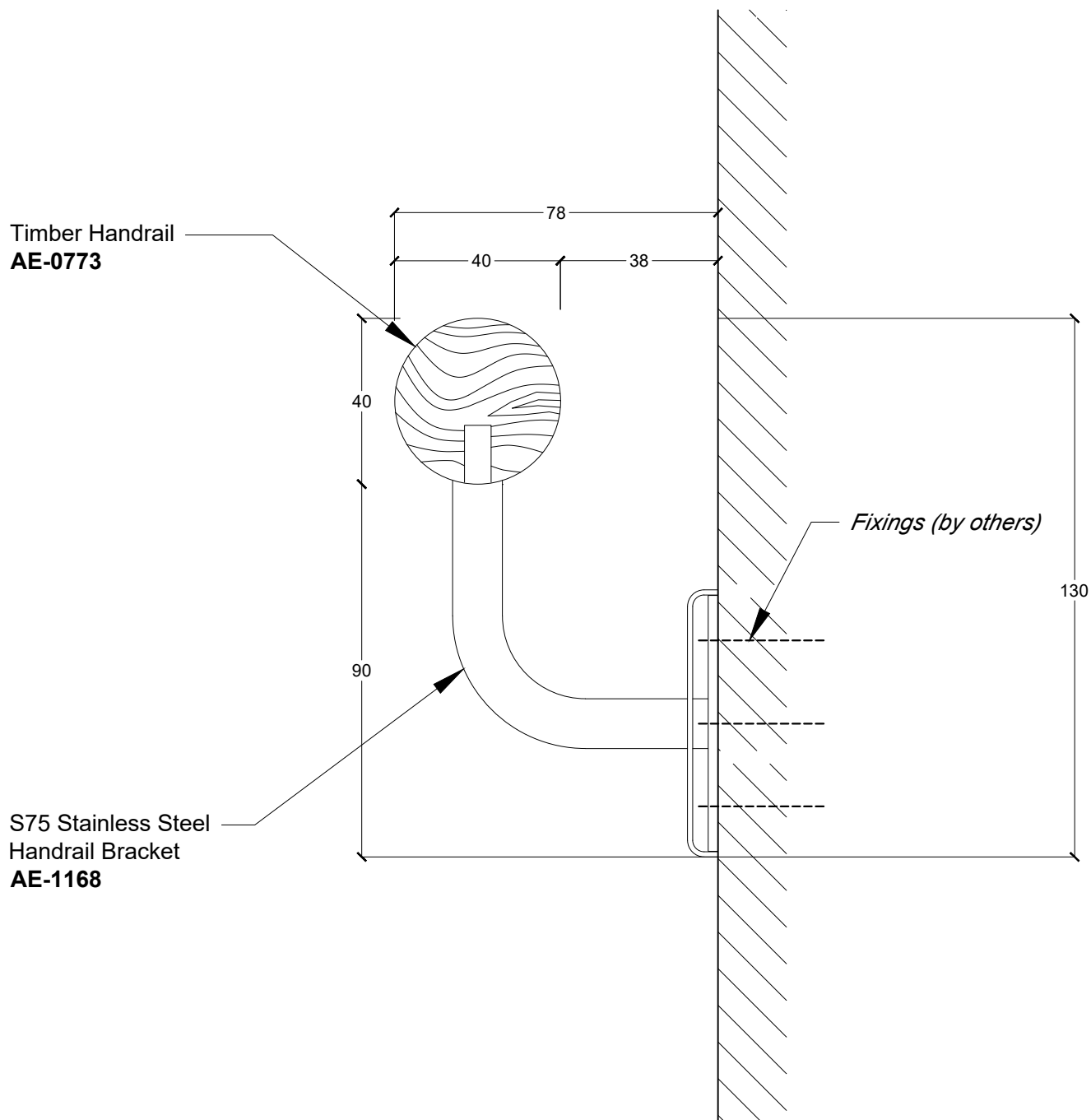

SECTION ON ELEVATION

HRW-6-S87

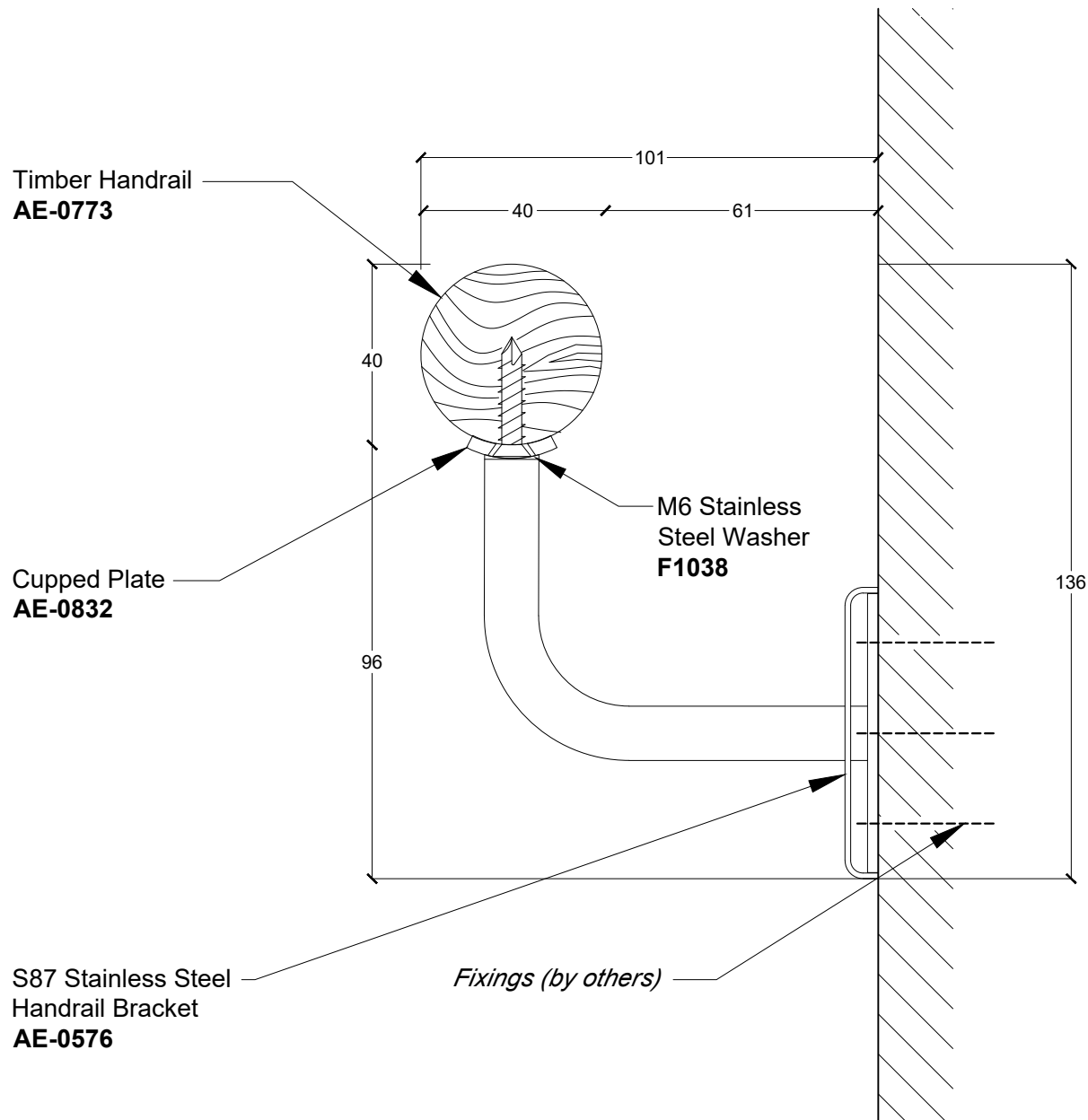

**COMPONENTS**

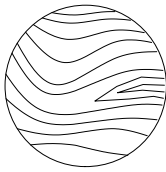

Timber Handrail  
**AE-0773**

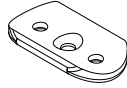

Cupped Plate  
**AE-0832**

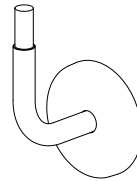

S75 Stainless Steel  
Handrail Bracket  
**AE-1168**

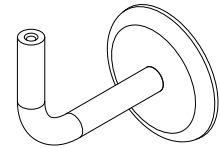

S87 Stainless Steel  
Handrail Bracket  
**AE-0576**



S87 Stainless Steel  
End Cap - LH  
**AE-0717**



S87 Stainless Steel  
End Cap - RH  
**AE-0716**



S75 Stainless Steel  
End Cap - LH  
**AE-1172**



S75 Stainless Steel  
End Cap - RH  
**AE-1173**



Stainless Steel Internal /  
External Corner  
**AE-0772**



S87 Timber End Cap  
Assembly  
**AE-1163**  
**AE-1165**



S75 Timber End Cap  
**AE-1162**



Timber Corner  
**AE-1163**



Timber Odd Angle  
Corner  
**AE-1164**



Stainless Steel  
Splice  
**AE-0763**



8 x 30mm  
Wooden Dowel  
**F1035**



8 x 50mm  
Wooden Dowel  
**F1023**

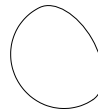

Rounded Timber  
End Stop  
**AE-1165**

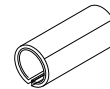

3 mm Seloc Pins  
**F0986**

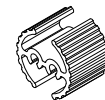

Handrail Spline  
**AE-0750**

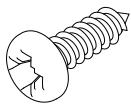

M5 x 12mm CSK Pozi  
**F0997**

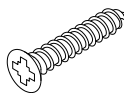

No.8 x 2" CSK Pozi  
**F0989**



No.8 x 1" CSK Pozi  
**F1036**



M6 Stainless  
Steel Washer  
**F1038**



Star Washer  
**F0963**

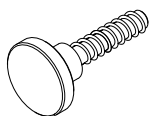

M5 x 30 Clamping Knob  
**F1032**



M5 Double  
Threaded Nut  
**F1033**

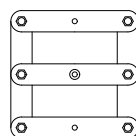

Centre Drilling Jig  
**AE-1299**

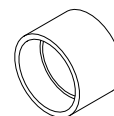

Spline Drilling Jig  
**AE-1300**

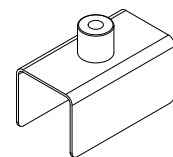

Drilling Jig for  
S75 Bracket  
**AE-1366**

All dimensions in millimeters unless otherwise stated. Do not scale from the drawing.

TYPICAL PLAN LAYOUT

HRW-6-S75 Timber

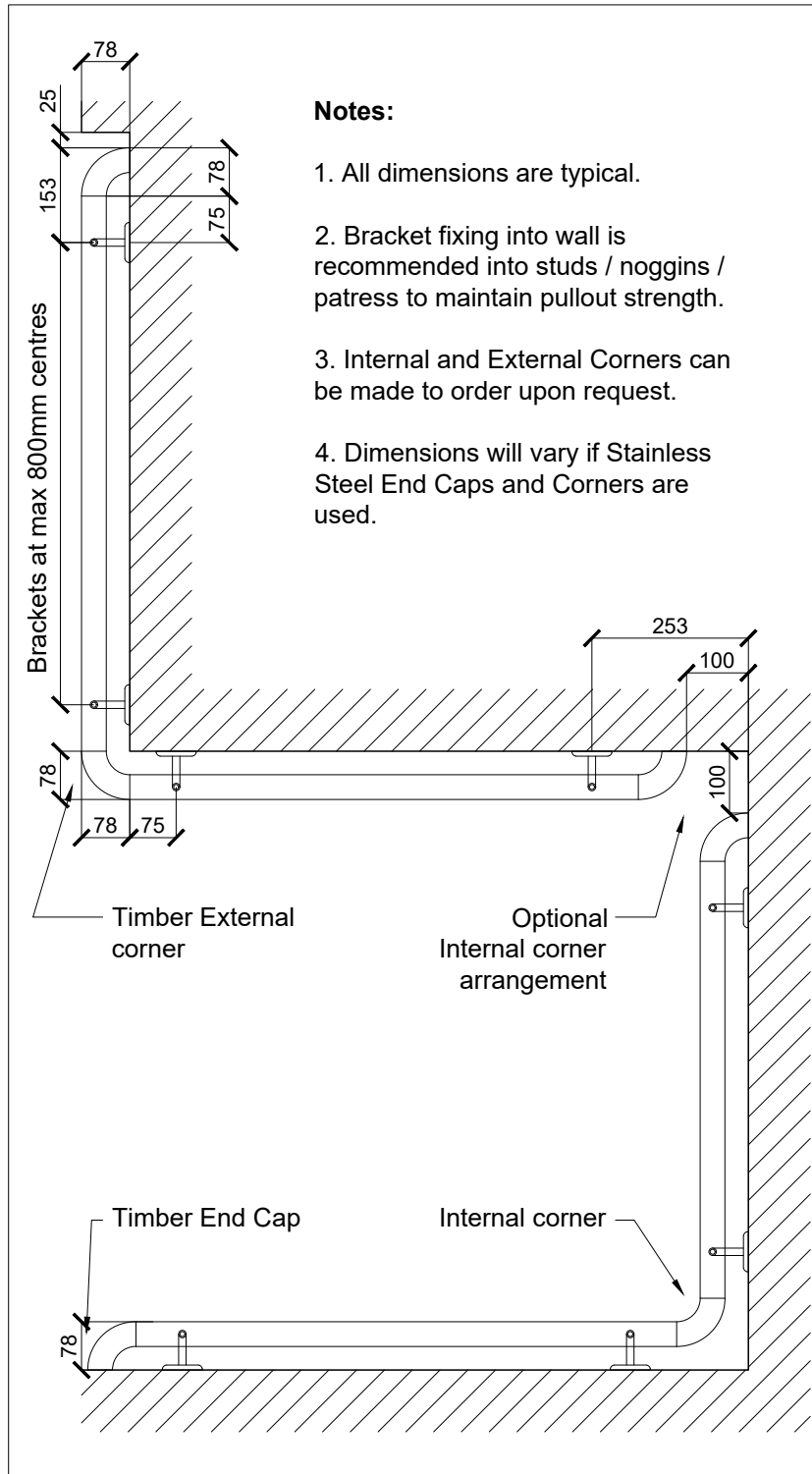

RETAINER CUTTING GUIDE

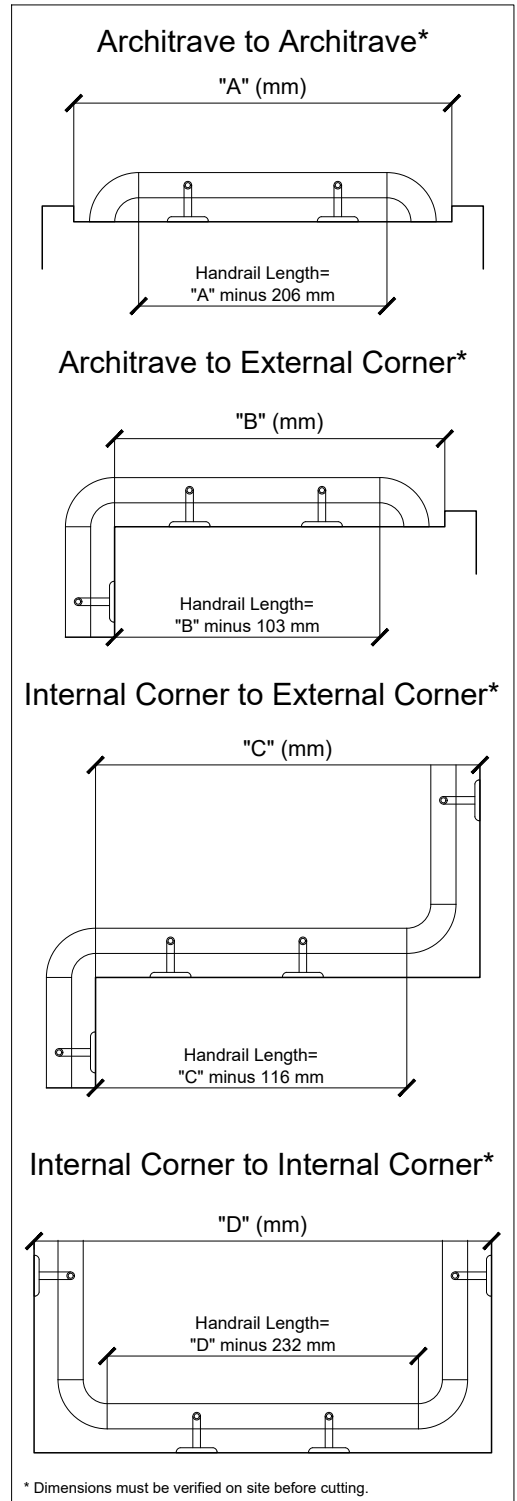

All dimensions in millimeters unless otherwise stated. Do not scale from the drawing.

**TYPICAL PLAN LAYOUT**

**HRW-6-S75 Stainless Steel**

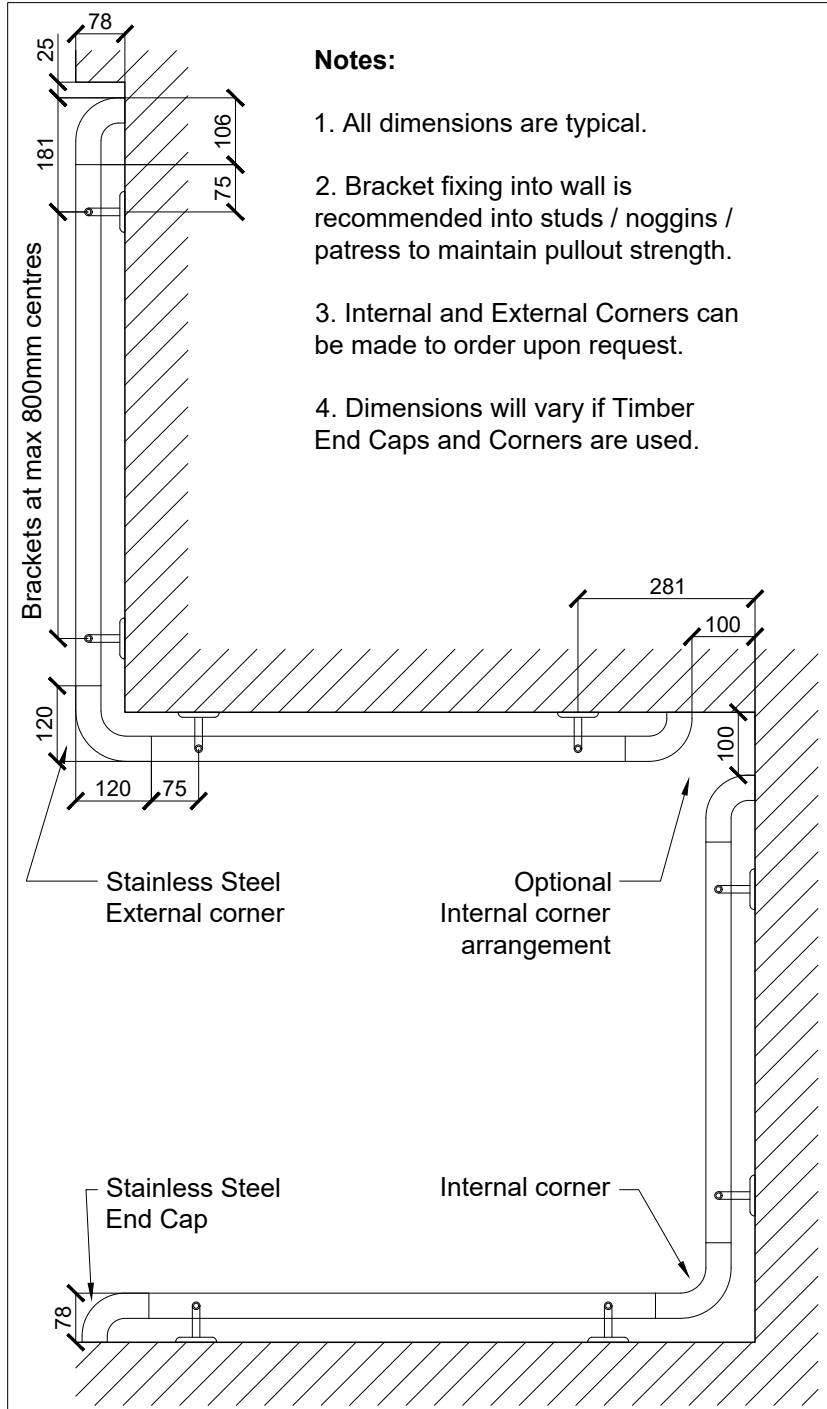

**RETAINER CUTTING GUIDE**

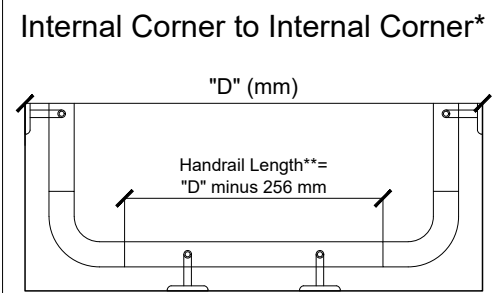
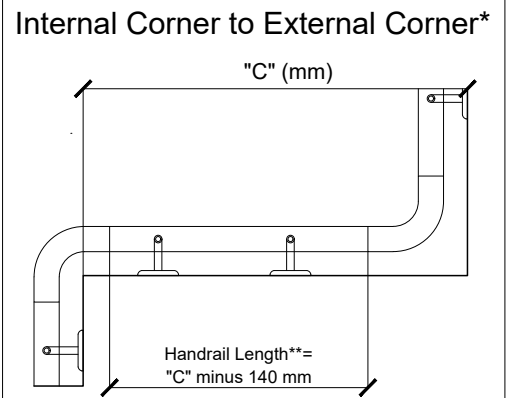
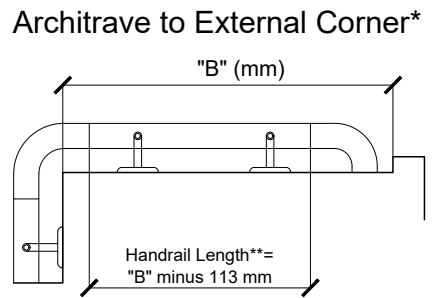
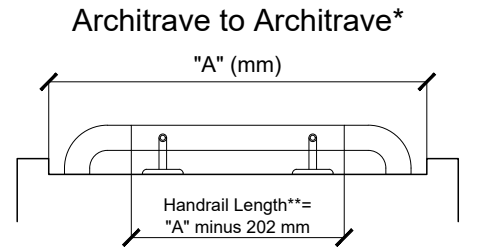

\* Dimensions must be verified on site before cutting.  
 \*\* Remove 60mm from the final handrail length if Timber Handrail Splines are to be supplied instead of Turned Down Ends on the Handrail.

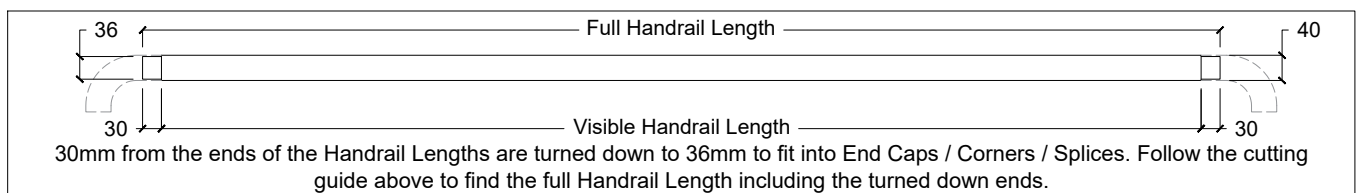

All dimensions in millimeters unless otherwise stated. Do not scale from the drawing.

TYPICAL PLAN LAYOUT

HRW-6-S87 Timber

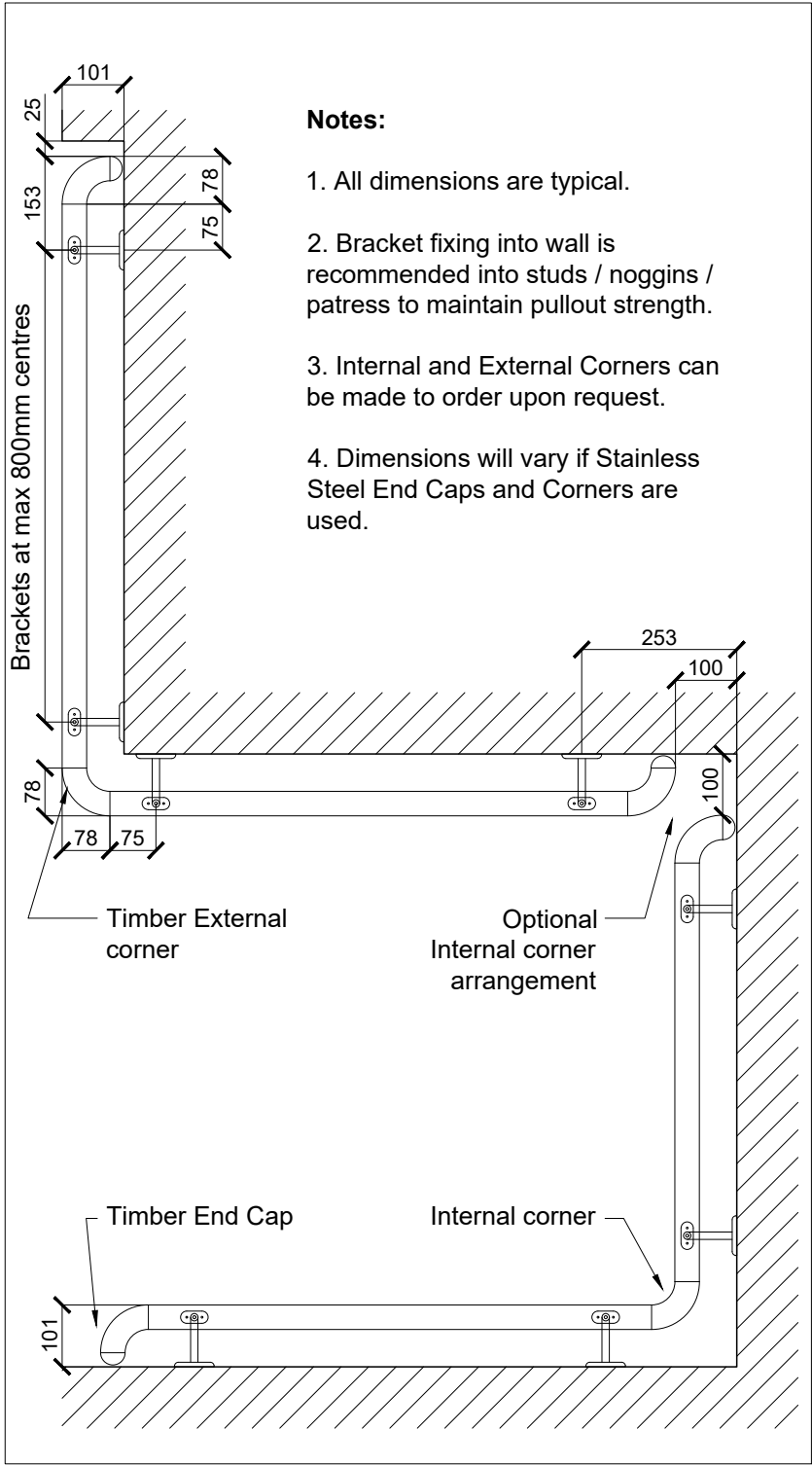

RETAINER CUTTING GUIDE

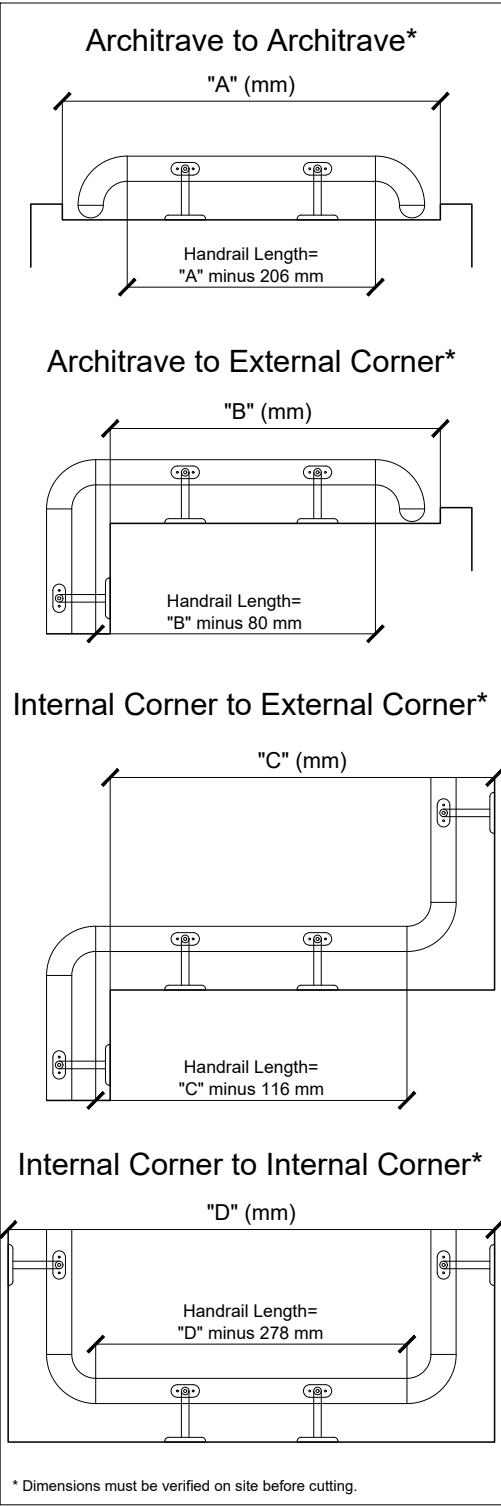

All dimensions in millimeters unless otherwise stated. Do not scale from the drawing.

**TYPICAL PLAN LAYOUT**

**HRW-6-S87 Stainless Steel**

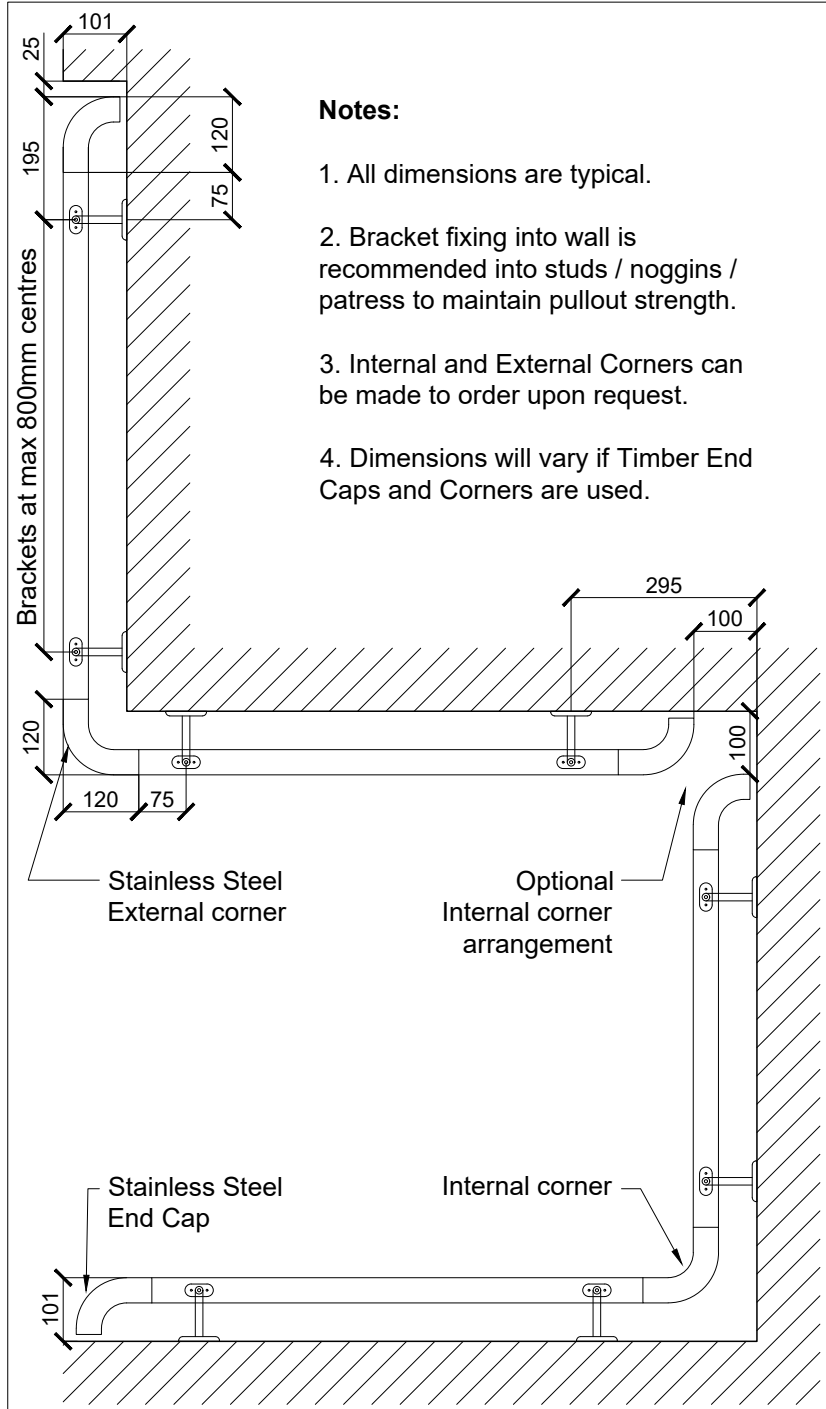

**RETAINER CUTTING GUIDE**

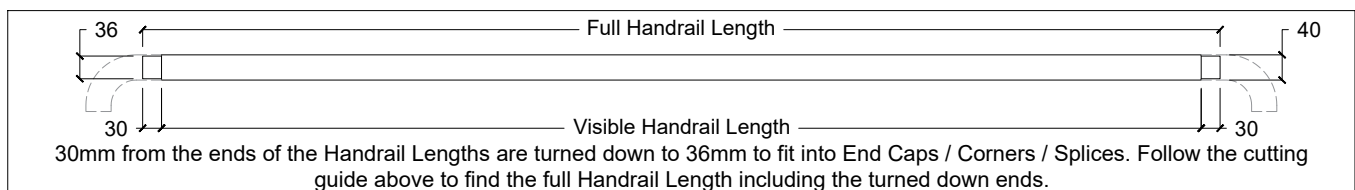
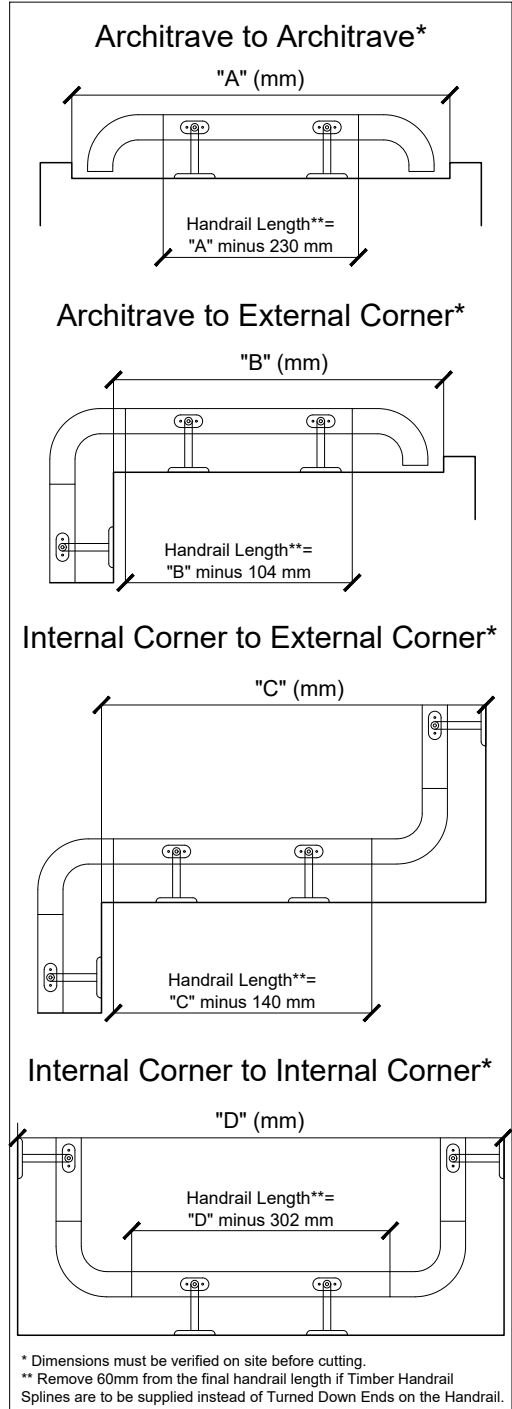

All dimensions in millimeters unless otherwise stated. Do not scale from the drawing.